

Technical data sheet

FLEXIBEL
DASHER BOARD SYSTEM

engo

ice arena equipment

ENG



FlexBoard2.0

PPS

DESIGNED FOR
HIGH-LEVEL MULTI-PURPOSE
ICE STADIUMS

2025-V03

Technical data sheet

FLEXIBEL DASHER BOARD SYSTEM

FlexBoard^{2.0}
PPS

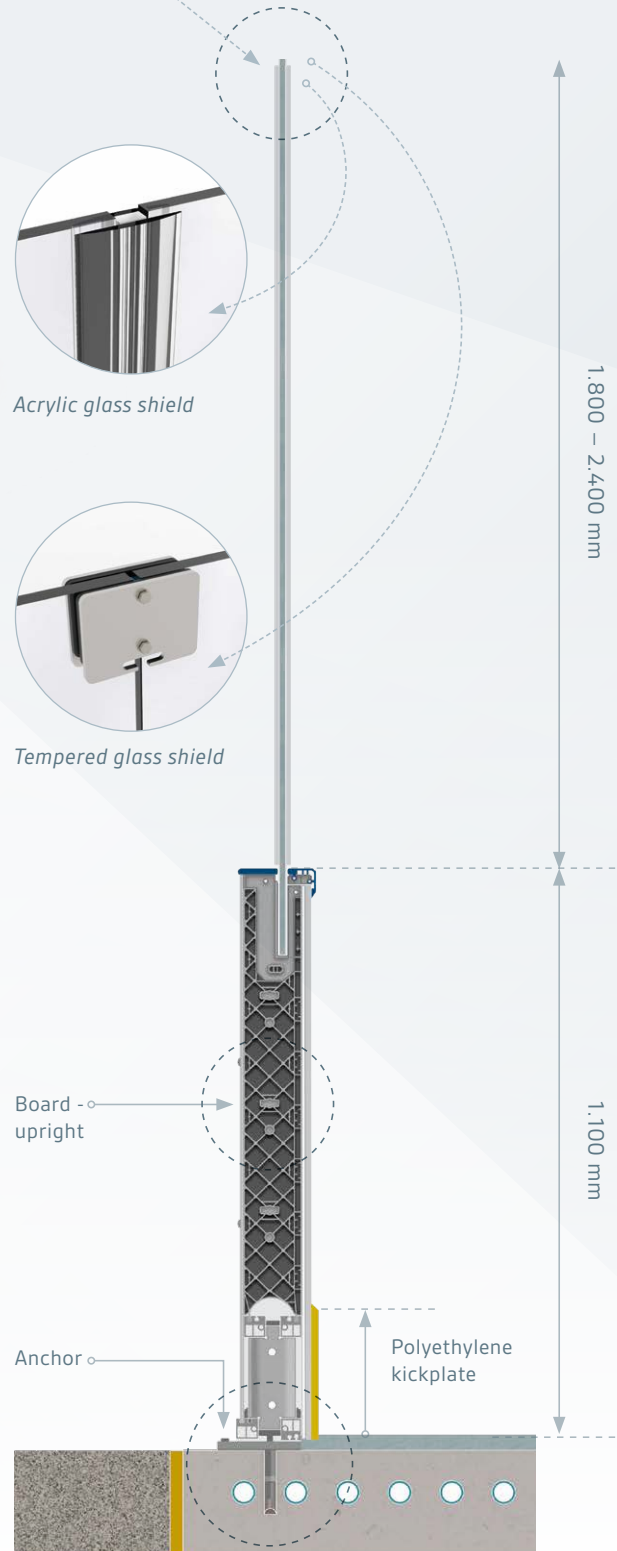
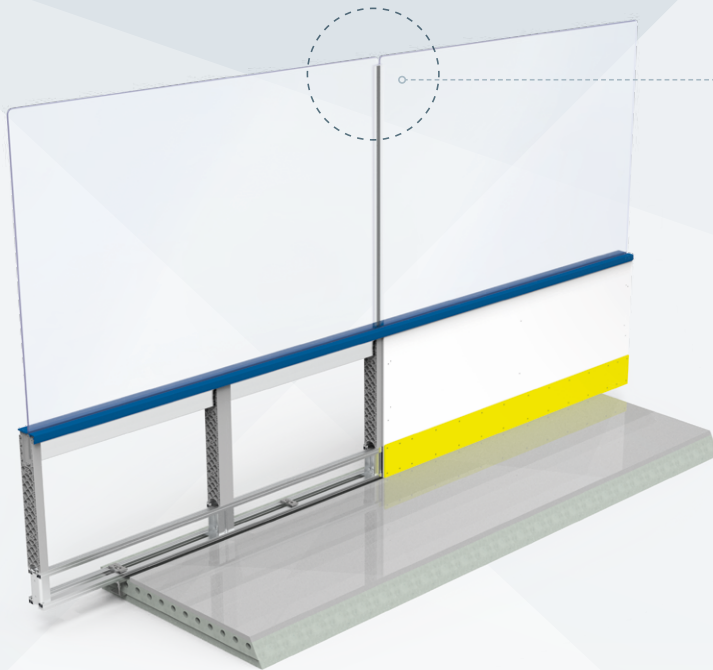

KEY FACTS

Technical specifications

RULES STANDARD	IIHF
HEIGHT Single element	1.100 mm
LENGHT Single element	to 3.000 mm
ELEMENT RADIUS	7 to 8,5 m
FRAME CONSTRUCTION	aluminum with flexible fiberglass-reinforced plastic uprights
ANCHOR TYPE	different mounting options
INSIDE PANELLING	polyethylene / white
KICKPLATE	polyethylene / yellow
HANDRAIL	made of soft, blue polymer
ENTRANCE DOOR	from 0,8 m
MACHINE GATE WIDTH PER DOOR	on demand

DASHER BOARD SYSTEM

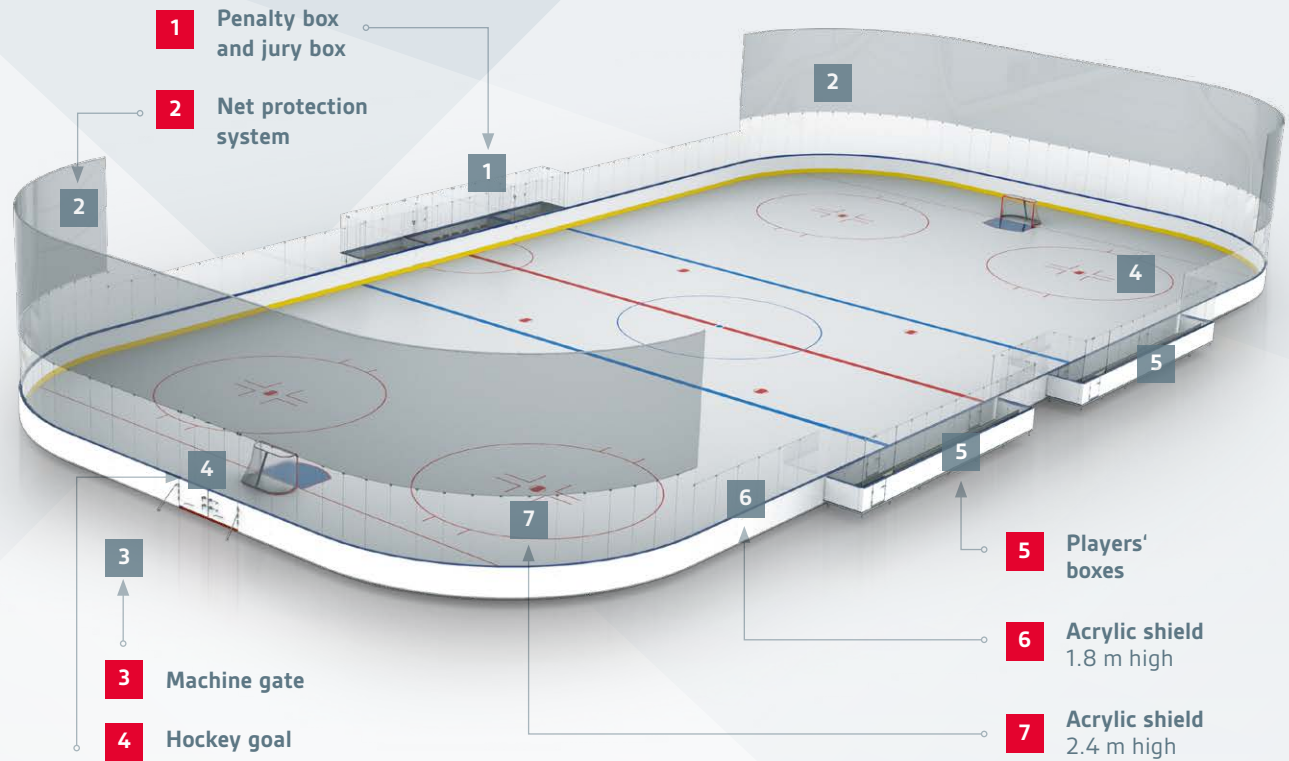

ANCHORING

Different installation possibilities

Installation into ice with steel plates

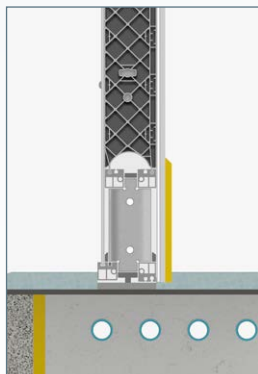

Installation system on a barrier

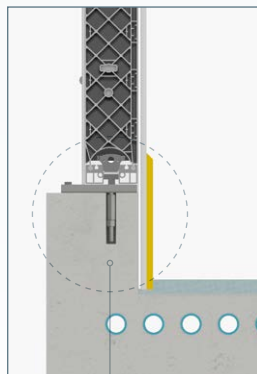

Immersed adhesive anchors

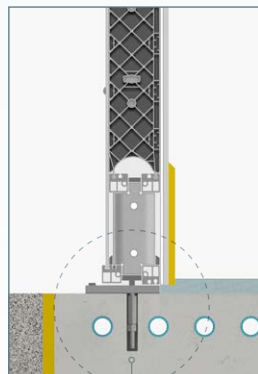

Anchoring system with ice dam

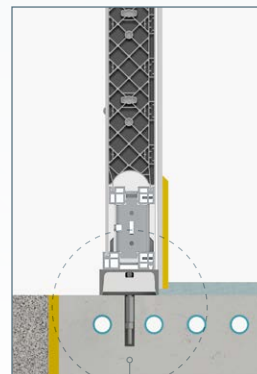

ALTERNATIVE:
Immersed steel rail in the concrete

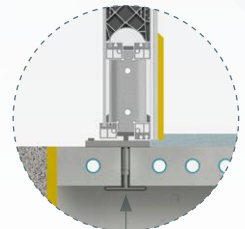

PLAYER PROTECTION SYSTEM

Flexibility for injury prevention

PPS stands for Player Protection System, because flexible board systems are able to absorb the loading of a player at impact and to reduce the risk of injuries. At engo, flexibility depends on a support post made of a special plastic-based composite that is reinforced with fiberglass.

What is unique about this product is the combination of a strong lower aluminum base, and a flexible, bendable upper part. They are the core components that together make up this incomparable board. A soft, polymer handrail further adds to the injury prevention factor; especially against serious head injuries.

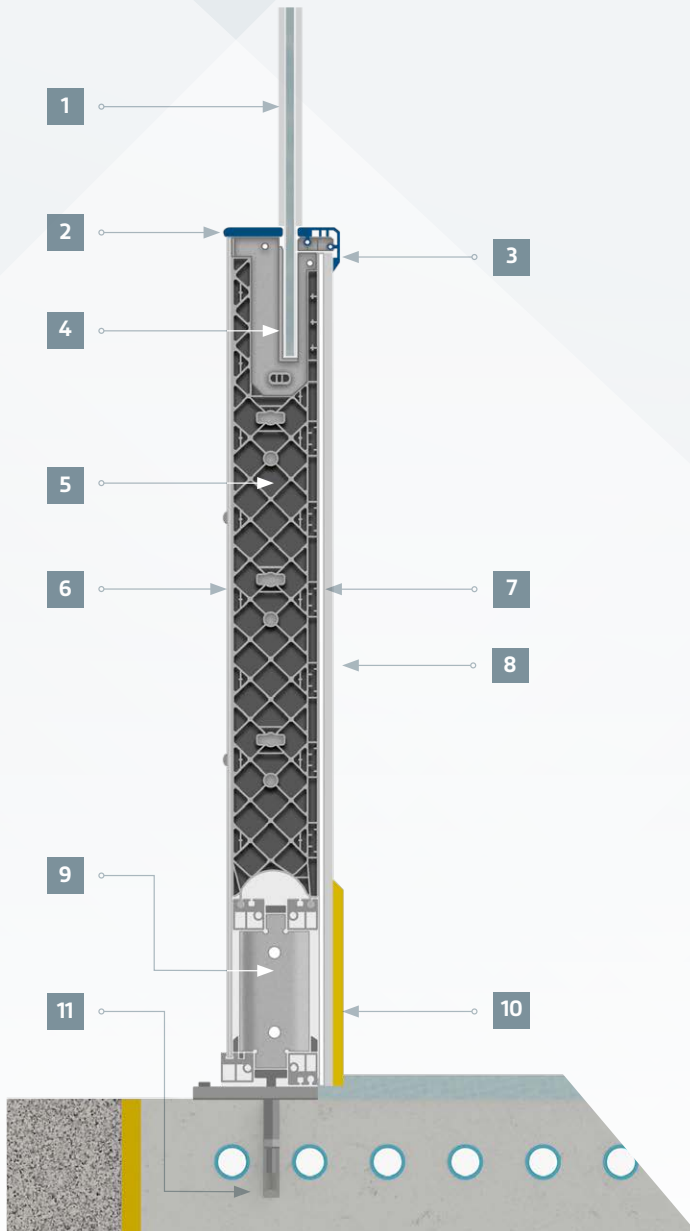

- 1** 15 mm acrylic shielding with glazing posts, up to 2.400 mm high (above the handrail) or as alternative 15/12 mm tempered glass shielding
- 2** External handrail made of PE HD
- 3** Soft rounded handrail made of polymer in blue with air chambers
- 4** PE fastening inserts, compatible with all types of glass shielding
- 5** Flexible board-upright made of fiberglass-reinforced plastic
- 6** Outside covering system made of PE-HD (10 mm thickness)
- 7** Inside covering system made of PE-HD (10 mm thickness)
- 8** Advertising panel – polystyrene (1mm thickness) covered with a 4 mm layer of polycarbonate
- 9** Base construction of aluminum
- 10** Yellow kick plate made of PE-HD (12 mm thickness)
- 11** Standard anchoring with immersed adhesive anchors in the concrete

OPTIONAL EQUIPMENT +



• ICE DAM



• QUICK ASSEMBLY SYSTEM



• TEMPERED GLASS SHIELDING *



• ACRYLIC SHIELDING **



• POLYCARBONATE SHIELDING ***



• MACHINE GATE INSIDE RADIUS



• ROUNDED SHIELDING ON BOXES



• SOUNDPROOFING



• OUTSIDE COVERING



• NET PROTECTION



• GOAL REFEREE BOX



• GOAL LIGHT



• ADVERTISING PROTECTION



• CUSTOM OPENINGS



• TRANSPARENT ELEMENTS



• TRANSPORT-, STORAGE SYSTEM

OTHER OPTIONS:

- STANDING RACK (ice stock) WITH STORAGE SYSTEM
- ICE COVERING
- QUICK ASSEMBLY COVER PPS 2.0
- RADIUS GLASS / BUFFER
- THE NEW BOARD DIVIDERS
- SHOOTING AREA

- LED-STRIPS IN POLYCARBONATE UPRIGHT
- GLASS STORAGE SYSTEM WITH / WITHOUT WHEELS

- PLAYER, JURY AND PENALTY BOXES
- QUICKADAPT
- MOTION: DASHER BOARD SYSTEM WITH INTEGRATED LED-FOIL

* Available as 12 mm, 15 mm or 12/15 mm thickness

** Available as 12 mm or 15 mm thickness

*** Available as 8 mm, 10 mm or 12 mm thickness

OPTIONAL EQUIPMENT +

PLAYERS' AND PENALTY BOXES

- **Players' boxes with „CoachWalkway“**
- **Benches** with back rest and bottle holder
- **Inspection** openings for players' box flooring
- **Players' boxes** with tempered glass
- **Roofing** for benches and jury box
- **Fully insulated and waterproof jury box** with jury table and 6 chairs
- **Straight dasher board elements, doors and folding floor** of the players' and penalty boxes for quick conversion to **Para Ice Hockey**.
- **Outdoor players' and penalty boxes** made of steel with polycarbonat roof, rubber floor and benches. Back rest and bottle holder available upon request at an extra charge.
- **Outdoor jury box** made of steel with polycarbonat roof, 1 door, rubber floor, jury table and 6 chairs.



Indoor
JURY BOX AND PENALTY BOXES

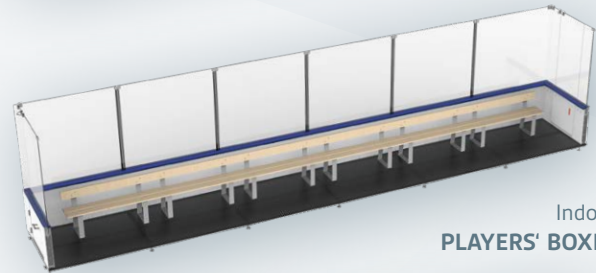

Indoor
PLAYERS' BOXES

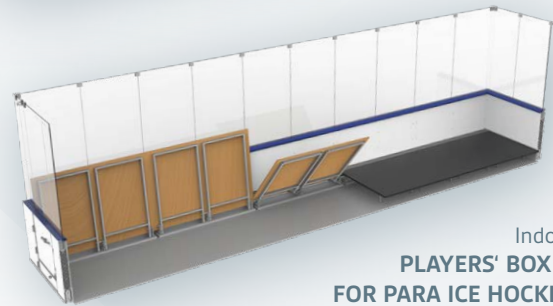

Indoor
PLAYERS' BOXES FOR PARA ICE HOCKEY

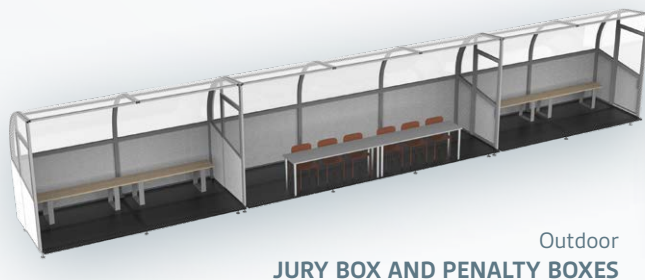

Outdoor
JURY BOX AND PENALTY BOXES

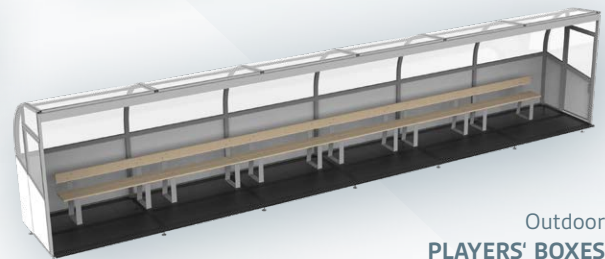

Outdoor
PLAYERS' BOXES



• **Rounded shielding**

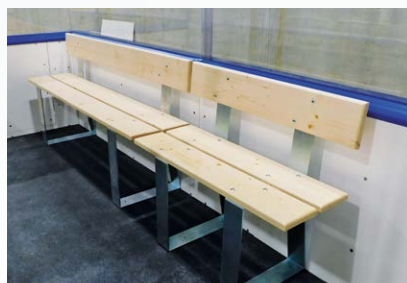

• **Benches with back rest**



Integrated bottle holder

OPTIONAL EQUIPMENT +



MORE INFO

QuickAdapt

- ✓ Avoid the high costs of a complete reconstruction of the rink
- ✓ Comply with IIHF regulations to host A-League championships
- ✓ Switch flexibly between the two sizes with one rink

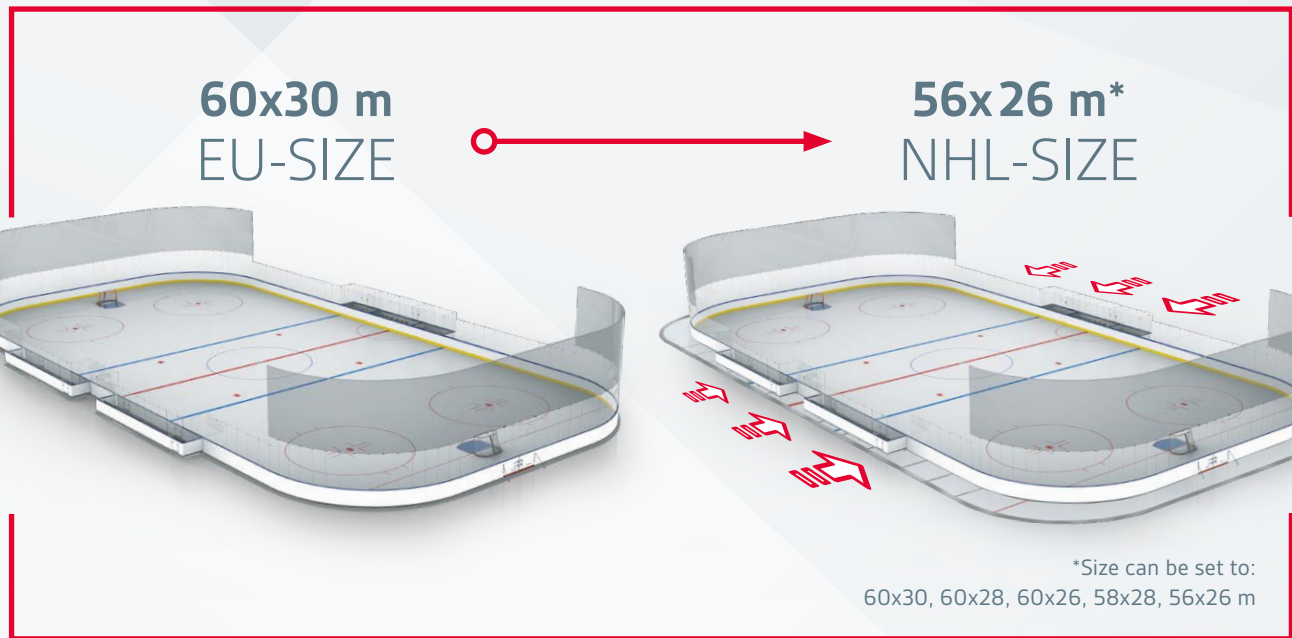

ONE SYSTEM, MANY SIZES

The innovative, patented QuickAdapt System is the cost-effective alternative to a complete rebuilding to reduce your ice rink to the NHL size. It moves the dasher board with the help of hydraulic cylinders reducing the size of the ice rink by 4 meters within 3 hours only.

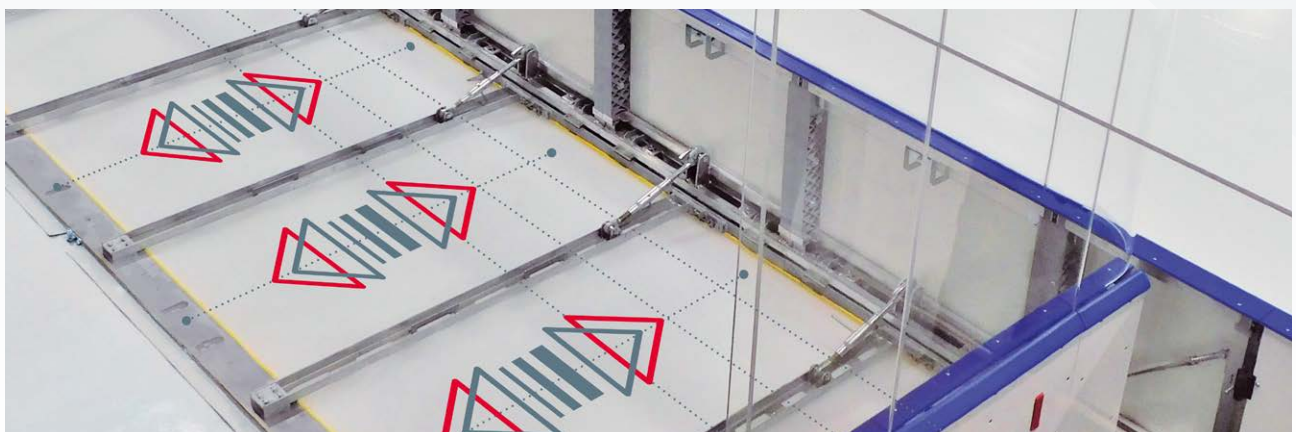

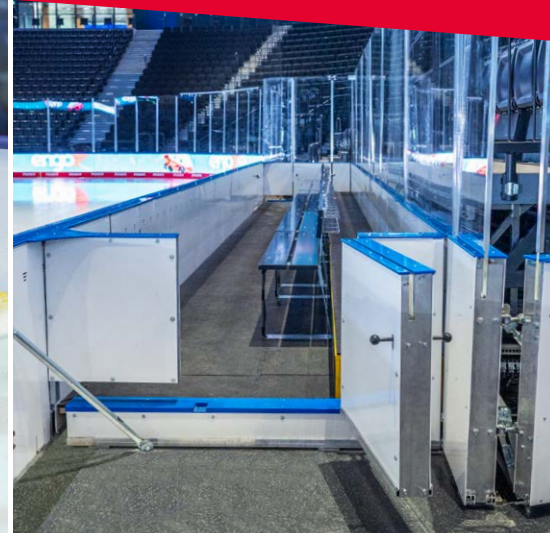

FLEXIBILITY & SAFETY TEST

Flexible dasher board systems are safer than conventional dasher board systems and protect players from more serious injuries by absorbing impacts. Engo was one of the first companies to recognise the advantages of these dasher board systems and develop a high-quality flexible board. This board is now known as FlexBoard PPS and was developed in co-operation with the Technical University of Dresden. The FlexBoard PPS now protects players worldwide from serious injuries.

There is more than one way to construct a flexible board. Impact tests show a clear difference between the boards. The results speak for themselves and show the exceptional properties of the FlexBoard PPS on straight and radius elements.

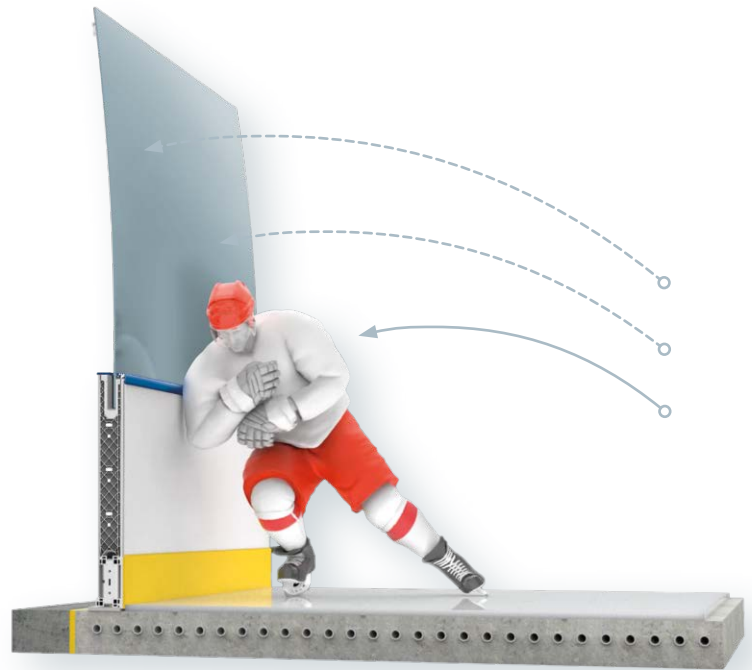

bfu tested
Compliant with
IIHF regulations



Ein Unternehmen der
TU Dresden AG
TUDAG

Results from 2022. This information sheet is to be used for promotional purposes only and information contained herein is subject to change by the manufacturer.



Website: www.engo-ice.cn

Hotline: 4009001881



**ICE RESURFACERS
DASHER BOARDS
ACCESSORIES**

*Powerful technology for
smooth ice surfaces since 1979*

*Specifications are subject to change.
For current product information
please contact the Engo Company.*

© Copyright by Engo

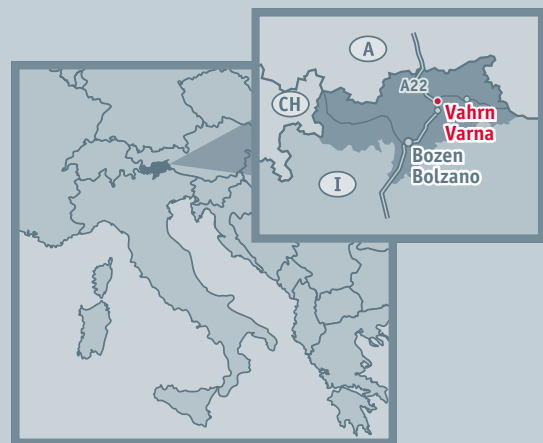

CERTIFICATION



MEMBER



LEGAL NOTICE
 Editor: Engo GmbH / S.r.l., Via Forch 9, 39040 Varna (BZ) Italia
 Pictures: Archive Engo, Photographer: City-Press GmbH Picture agency, mm design, Christof Schiner, FOTO KLICK, Hannes Niederkofler,
 Vanna Antonello, Exide Technologies, ROYPOW Industrial Park, Adobe Stock – www.stock.adobe.com, Sportpoint, Gorodenkoff Productions OU, siderovstock,
 Von 103inn, Sidijk / Md., www.shutterstock, iStock – www.istockphoto.com: il-graphics, JuSun, BongkarnThanayakij, dabooat, Design by almedes.bz